



### Tea ridotte Reduced tee



#### Descrizione Description

A completamento dei sistemi di tubazioni fusio-technik, aquatechnik offre una vasta ed esauriente serie di raccordi realizzata in PP-R 80 Super, PP-RCT e a settori con tubazioni faser fiber-LIGHT. La gamma comprende raccordi di transizione, parti terminali realizzate con inserto in metallo filettato maschio e femmina, giunti flangiati, valvole, oltre che raccordi d'integrazione che consentono di congiungere e creare collegamenti con tutti i sistemi di tubazioni e raccordi proposti dall'azienda.

La giunzione tra le parti avviene tramite polifusione (saldatura a bicchiere fino al Ø 125 mm, testa a testa per i diametri con dimensioni superiori), processo che garantisce la massima sicurezza di tenuta anche nelle condizioni di impiego più estreme.

La costante attenzione alle richieste e alle esigenze di mercato ha inoltre portato aquatechnik alla creazione di un apposito reparto produttivo capace di realizzare collettori e pezzi speciali su specifiche richieste di progetto.

Tale reparto è supportato da uno studio tecnico composto da personale qualificato che, oltre a gestire la parte progettuale necessaria alla realizzazione dei particolari creati su misura del cliente, e in grado di guidare lo stesso nella scelta della più appropriata tipologia di prodotto, in funzione delle condizioni d'impiego.

As a completion of the fusio-technik piping systems, Aquatechnik offers a wide and exhaustive range of fittings made in PP-R 80 Super, PP-RCT and in sectors with faser fiber-LIGHT pipes. The range includes transition fittings, terminal parts realized with threaded male and female insert in metal, flange joints, valves, as well as integration fittings that allow to join and create connections with every system of pipes and fittings proposed by the company.

The junction among the parts is made by polyfusion (coupling welding until Ø 125 mm, butt-welding for diameters with higher dimensions), process that guarantees the highest tightness safety even in the most extreme utilization conditions.

The constant attention to the demands and requirements of the market has led Aquatechnik to the creation of special production department able to realize manifolds and special parts on specific project demands.

This department is supported by a technical study composed of qualified staff that, not only takes care of the projects necessary to realize special parts upon customers' order, but is also able to suggest the customer the best choice of the most appropriate typology of product, according to the utilization conditions.

#### Specifiche prodotto Product specifications

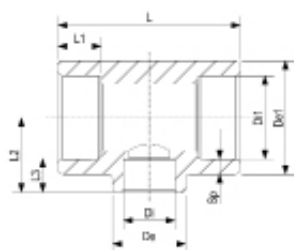

#### TEE RIDOTTE, a saldare in PP-R REDUCED TEE, to weld in PP-R

Articolo Code	SDR	DN	De	Di	De1	Di1	L	L1	L2	L3	Sp	Peso Wt.	Conf. Pack.	Scatola Box
			mm	mm	mm	mm	mm	mm	mm	mm	mm	gr	pz	pz
64218	5	20-25-20	34,5	25,0	34,5	20,0	60,0	14,5	30,0	16,0	7,25	43	10	150
64220	5	25-20-20	34,5	20,0	34,5	20,0	60,0	16,0	30,0	14,5	7,25	38	10	150
64222	5	25-20-25	34,5	20,0	34,5	25,0	60,0	16,0	30,0	14,5	4,75	36	10	150
64232	5	32-25-25	43,5	25,0	43,5	25,0	71,0	18,0	33,0	16,0	9,25	62	5	100
64234	5	32-20-25	34,5	20,0	43,5	32,0	71,0	18,0	33,0	14,5	5,75	61	5	100
64240	5	32-25-32	34,5	25,0	43,5	32,0	71,0	18,0	33,0	16,0	5,75	58	5	100
64242	5	40-20-40	34,5	20,0	53,5	40,0	86,0	20,5	35,3	14,5	6,75	103	5	120
64244	5	40-25-40	34,5	25,0	53,5	40,0	86,0	20,5	35,3	16,0	6,75	99	5	120
64245	5	40-32-32	53,5	32,0	53,5	32,0	86,0	20,5	43,0	18,0	10,75	124	5	100
64246	5	40-32-40	53,5	32,0	53,5	40,0	86,0	20,5	43,0	18,0	6,75	123	5	100
64247	5	50-20-50	34,5	20,0	68,0	50,0	101,0	23,5	44,0	14,5	9,00	225	5	60
64248	5	50-25-50	43,5	25,0	68,0	50,0	101,0	23,5	44,0	16,0	9,00	225	5	60
64250	5	50-32-50	43,5	32,0	68,0	50,0	101,0	23,5	44,0	18,0	9,00	225	5	60
64251	5	50-40-50	68,0	40,0	68,0	50,0	101,0	23,5	50,5	20,5	9,00	240	5	60
64252	5	63-20-63	34,5	20,0	85,0	63,0	122,0	27,5	52,5	14,5	11,00	410	1	35
64254	5	63-25-63	34,5	25,0	85,0	63,0	122,0	27,5	52,5	16,0	11,00	400	1	35
64256	5	63-32-63	53,5	32,0	85,0	63,0	122,0	27,5	52,5	18,0	11,00	410	1	35



## TEE ridotte Reduced tee



### Specifiche prodotto Product specifications

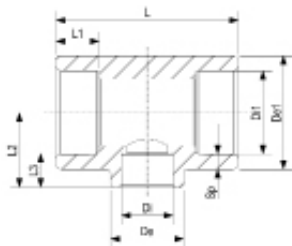

TEE RIDOTTE, a saldare in PP-R  
REDUCED TEE, to weld in PP-R

Articolo Code	SDR	DN	De	Di	De1	Di1	L	L1	L2	L3	Sp	Peso Wt.	Conf. Pack.	Scatola Box
			mm	mm	mm	mm	mm	mm	mm	mm	mm	gr	pz	pz
64258	5	63-40-63	53,5	40,0	85,0	63,0	122,0	27,5	52,5	20,5	11,00	400	1	35
64260	5	63-50-63	85,0	50,0	85,0	63,0	122,0	27,5	61,0	23,5	11,00	465	1	30
64261	5	75-20-75	34,5	20,0	101,0	75,0	146,0	30,0	58,0	14,5	13,00	630	1	25
64262	5	75-25-75	34,5	25,0	101,0	75,0	146,0	30,0	58,0	16,0	13,00	630	1	25
64264	5	75-32-75	53,5	32,0	101,0	75,0	146,0	30,0	64,0	18,0	13,00	630	1	25
64266	5	75-40-75	53,5	40,0	101,0	75,0	146,0	30,0	64,0	20,5	13,0	630	1	25
64268	5	75-50-75	85,0	50,0	101,0	75,0	146,0	30,0	70,0	23,5	13,0	630	1	25
64270	5	75-63-75	85,0	63,0	101,0	75,0	146,0	30,0	70,0	27,5	13,0	680	1	16
64280	5	90-50-90	85,0	50,0	120,0	90,0	160,0	33,0	74,0	23,5	15,0	815	1	16
64282	5	90-63-90	85,0	63,0	120,0	90,0	160,0	33,0	74,0	27,5	15,0	780	1	16
64284	5	90-75-90	120,0	75,0	120,0	90,0	160,0	33,0	80,0	30,0	15,0	915	1	16
64286	5	110-63-110	101,0	63,0	147,0	110,0	194,0	37,0	85,7	27,5	18,5	1650	1	10
64288	5	110-75-110	101,0	75,0	147,0	110,0	194,0	37,0	85,7	30,0	18,5	1620	1	10
64290	5	110-90-110	147,0	90,0	147,0	110,0	194,0	37,0	97,0	33,0	18,5	1780	1	10
64294	5	125-90-125	120,0	90,0	164,0	125,0	244,0	40,0	106,0	33,0	19,5	2510	1	5
64296	5	125-110-125	147,0	110,0	164,0	125,0	244,0	40,0	110,0	37,0	19,5	2560	1	5

### Specifiche prodotto Product specifications

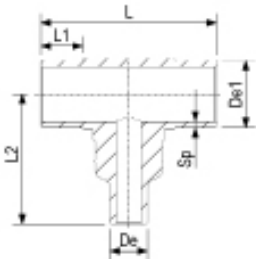

TEE, saldatura testa a testa, a saldare in PP-RCT  
TEE, butt-welding, to weld in PP-RCT

Articolo Code	SDR	DN	De	De1	L	L1	L2	Sp	Peso Wt.	Conf. Pack.	Scatola Box
			mm	mm	mm	mm	mm	mm	gr	pz	pz
64298U	11	160-90-160	90,0	160,0	420,0	101,0	314,0	14,6	5100	1	2
64299U	11	160-110-160	110,0	160,0	420,0	101,0	314,0	14,6	5100	1	2
64300U	11	160-125-160	125,0	160,0	420,0	101,0	314,0	14,6	5000	1	2
64302U	11	200-160-200	160,0	200,0	490,0	115,0	420,0	18,2	9500	1	
64306U	11	250-160-250	160,0	250,0	610,0	142,0	480,0	22,7	17800	1	
64307U	11	250-200-250	200,0	250,0	610,0	142,0	480,0	22,7	17800	1	
643094U	11	315-200-315	200,0	315,0	776,0	178,0	700,0	28,5	35500	1	
643096U	11	315-250-315	250,0	315,0	776,0	178,0	700,0	28,5	35200	1	



**Specifiche prodotto**  
**Product specifications**

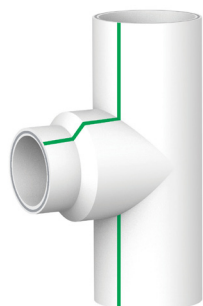
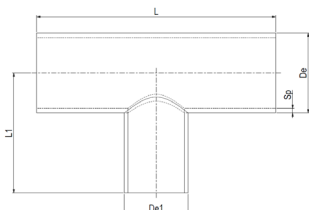

**GOMITO A 45°**, saldatura testa a testa, realizzato a settori con tubo faser FIBER-LIGHT  
**ELBOW 45°**, butt-welding, made in sectors with FIBER-LIGHT faser pipe

Articolo Code	SDR	DN	De	De1	L	L1	Sp	Peso Wt.	Conf. Pack.	Scatola Box
			mm	mm	mm	mm	mm	gr	pz	pz
64300UZ	17,6	160-125-160	160,0	125,0	480,0	275,0	9,1	2784	1	
64302UZ	17,6	200-160-200	200,0	160,0	600,0	300,0	11,4	4454	1	
64306UZ	17,6	250-160-250	250,0	160,0	750,0	375,0	14,2	8170	1	
64307UZ	17,6	250-200-250	250,0	200,0	750,0	375,0	14,2	9321	1	
643094UZ	17,6	315-200-315	315,0	200,0	915,0	457,5	17,9	15765	1	
643096UZ	17,6	315-250-315	315,0	250,0	915,0	457,5	17,9	18024	1	
643124UZ	17,6	355-315-355	355,0	315,0	955,0	477,5	20,1	24041	1	
643154UZ	17,6	400-355-400	400,0	355,0	1200,0	600,0	22,7	38914	1	

**Caratteristiche tecniche**  
**Technical specifications**

**Materia prima:**

- gamma SDR 5: PP-R Super 80 (polipropilene copolimero random)
- gamma SDR 11: PP-RCT (polipropilene copolimero random a cristallinità modificata)
- gamma SDR 17,6: vedere scheda tecnica tubo faser fiber-LIGHT (n. 156)

**Colore:**

- gamma SDR 5 (gomito a 45° femmina/femmina e maschio/femmina): verde
- gamma SDR 11: bianco
- gamma SDR 17,6: bianco con strisce verdi

**Misure:** da Ø 20 a Ø 400 mm

**Spessore:**

- da Ø 20 a Ø 125 mm: SDR 5
- da Ø 160 a Ø 315 mm: SDR 11 e SDR 17,6
- da Ø 355 a Ø 400 mm: SDR 17,6

**Marcatura:** tutti i raccordi della gamma fusio-technik (salvo quando le ridotte dimensioni dei pezzi non lo consentono) riportano i riferimenti aziendali, il periodo di fabbricazione, le misure del pezzo

**Raw material:**

- range SDR 5: PP-R Super 80 (polypropylene random copolymer)
- range SDR 11: PP-RCT (polypropylene random copolymer with modified crystallinity)
- range SDR 17,6: see faser fiber-LIGHT pipe data sheet (n. 156)

**Colour:**

- range SDR 5 (elbow 45° female/female end male/female): green
- range SDR 11: white
- range SDR 17,6: white with green stripes

**Sizes:** from Ø 20 to Ø 400 mm

**Thickness:**

- from Ø 20 to Ø 125 mm: SDR 5
- from Ø 160 to Ø 315 mm: SDR 11 and SDR 17,6
- from Ø 355 to Ø 400 mm: SDR 17,6

**Marking:** all the fittings of the fusio-technik range (except when the small part dimensions do not allow so) carry the company details, the production period, the part dimensions

**Norme di riferimento**  
**Reference standards**

Prodotto in conformità ai requisiti richiesti dalla normativa Europea EN ISO 15874, DIN 8077 e 8078, al DM 174 e alla ASTM F2389.

Produced in accordance with the requirement of the European standard EN ISO 15874, DIN 8077 and DIN 8078, DM 174 and ASTM F2389.



### Tea ridotte Reduced tee

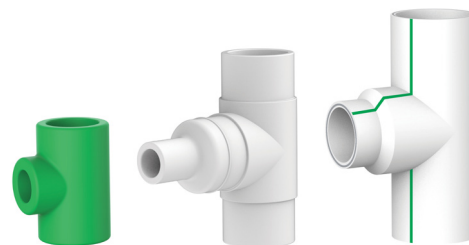

#### Norme di riferimento Reference standards

Prodotto in conformità ai requisiti richiesti dalla normativa Europea EN ISO 15874, DIN 8077 e 8078, al DM 174 e alla ASTM F2389.

*Produced in accordance with the requirement of the European standard EN ISO 15874, DIN 8077 and DIN 8078, DM 174 and ASTM F2389.*

#### Campi di impiego Fields of application



 Consigliato per vantaggi tecnici  
*Recommended for technical advantages*

Utilizzabili con tutte le gamme di tubazioni fusio-technik nei relativi ambiti di impiego.

*They can be used with every fusio-technik pipe ranges in their related application fields.*

 Possibile impiego  
*Possible use*

Raccorderia idonea al trasporto di acqua potabile calda e fredda.

*Fittings suitable for the transport of hot and cold drinking water.*

Per la correlazione tra pressione e temperatura d'esercizio, fare sempre riferimento alle condizioni d'esercizio definite per le tubazioni, riportate nella relativa documentazione tecnica.

*For the correlation between pressure and operating temperature, always refer to the operating conditions defined for the pipes, shown in the relative technical documentation.*

Per la realizzazione di impianti veicolanti liquidi e/o sostanze diverse, consultare preventivamente i nostri uffici tecnici (tel. +39 (0)331 307015, fax +39 (0)331 306923, e-mail: ufficio.tecnico@aquatechnik.it).

*To set up for the conveyance of liquids and/or different substances, contact our technical department (tel. +39 0331 307015, fax +39 0331 306923, e-mail: ufficio.tecnico@aquatechnik.it).*

#### Voce di capitolato Specification item

##### Gamma SDR 5

Serie completa di raccordi a tee ridotti, SDR 5, per tubazioni da Ø 20 a 125 mm. Realizzata completamente in PP-R Super 80 (polipropilene copolimero random) prodotto mediante stampaggio. Giunzione con tubazioni mediante saldatura a tasca. Prodotto in conformità ai requisiti richiesti dalla normativa Europea UNI EN ISO 15874-3, DIN 8077 e 8078, al DM 174 e ASTM F2389 per il trasporto di acqua calda e fredda destinata al consumo umano, per riscaldamento, condizionamento, aria compressa ed impianti meccanici in genere. Adatto alla veicolazione di fluidi ad una temperatura massima in esercizio in continuo di 80°C per 10 anni ad una pressione massima di 10,0 bar (con SF=1,5). Adatto al contatto con acqua potabile. Colore: verde. Marca: aquatechnik.

##### Range SDR 5

*Complete range of reduced tee fittings, SDR 5, for pipings from Ø 20 to 125 mm. Completely made in PP-R Super 80 (polypropylene random copolymer) by injection moulding. Junction with pipings through coupling welding (polyfusion). Produced in accordance with the requirements of the European Standard UNI EN ISO 15874-3, DIN 8077/8078, DM 174 and ASTM F2389, for the transport of potable hot and cold water intended for human consumption, for warming, conditioning, compressed air and mechanical systems in general. Suitable for the conveyance of fluids at a maximum continuous working temperature of 80°C for 10 years at a maximum pressure of 10,0 bar (with SF=1,5). It is suitable for the contact with potable water. Colour: green. Brand: Aquatechnik.*

##### Gamma SDR 11

Serie completa di raccordi a tee ridotte, SDR 11, per tubazioni da Ø 160 a 315 mm. Realizzata completamente in PP-RCT (polipropilene copolimero random a cristallinità modificata) prodotto mediante stampaggio. Giunzione con tubazioni mediante saldatura testa a testa. Prodotto in conformità ai requisiti richiesti dalla normativa Europea UNI EN ISO 15874-3, DIN 8077 e 8078, al DM 174 e alla ASTM F2389, per il trasporto di acqua calda e fredda destinata al consumo umano, per riscaldamento, condizionamento, aria compressa ed impianti meccanici in genere. Sistema adatto alla veicolazione di fluidi ad una temperatura massima in esercizio in continuo di 40°C per 100 anni

##### Range SDR 11

*Complete range of reduced tee fittings, SDR 11, for pipings from Ø 160 to 315 mm. Completely made in PP-RCT (polypropylene random copolymer with modified crystallinity) by injection moulding. Junction with pipings through coupling butt-welding. Produced in accordance with the requirements of the European Standard UNI EN ISO 15874-3, DIN 8077/8078, DM 174 and ASTM F2389, for the transport of potable hot and cold water intended for human consumption, for warming, conditioning, compressed air and mechanical systems in general. Suitable for the conveyance of fluids at a maximum continuous working temperature of 40°C for 100 years at a maximum pressure*



## Tee ridotte Reduced tee



### Voce di capitolato Specification item

ad una pressione massima di 12,8 bar (con SF=1,5) ed un temperatura massima limite di 70°C a 7,9 bar per 50 anni (con SF=1,5). Adatto al contatto con acqua potabile. Colore: bianco. Marca: aquatechnik.

#### Gamma SDR 17,6

Serie completa di raccordi a tee ridotti, SDR 17,6, per tubazioni da Ø 160 a 400 mm. Realizzata mediante la saldatura (testa a testa) di spezzoni di tubo faser fiber-LIGHT prodotti con PP-RCT (polipropilene copolimero random pressure resistance) per lo strato interno, in PP-RF (polipropilene copolimero random caricato con fibre di vetro) per lo strato intermedio e PP-R (polipropilene copolimero random) per lo strato esterno. Giunzione con tubazioni mediante saldatura testa a testa. Prodotto in conformità ai requisiti richiesti dalle normative UNI EN ISO 15874-2, 15874-5 e DIN 8077 e 8078 (relativamente alle dimensioni e campi di pressioni per tubazioni in polipropilene), ASTM F2389, per il trasporto di acqua calda e fredda destinata al consumo umano, per riscaldamento, condizionamento, aria compressa ed impianti meccanici in genere. Sistema adatto alla veicolazione di fluidi ad una temperatura massima in esercizio in continuo di 80°C per 25 anni ad una pressione massima di 4,8 bar (con SF=1,25) ed un temperatura massima limite di 95°C a 3,6 bar per 10 anni (con SF=1,25). Adatto al contatto con acqua potabile. Colore: bianco con strisce verdi. Marca: aquatechnik.

of 12,8 bar (with SF=1,5) and a maximum limit temperature of 70°C at 7,9 bar for 50 years (with SF=1,5). It is suitable for the contact with potable water. Colour: white. Brand: Aquatechnik.

#### Range SDR 17,6

Complete range of reduced tee fittings, SDR 17,6, for pipings from Ø 160 to 400 mm. Made by welding (head-to-head) sections of faser fiber-LIGHT pipe made in PP-RCT (pressure resistance polypropylene random copolymer) for the internal layer, PP-RF (polypropylene random copolymer loaded with glass fibre) for the intermediate layer, (PP-R polypropylene random copolymer) for the external layer. Junction with pipings through coupling butt-welding. It's produced in accordance with the requirements of standards UNI EN ISO 15874-2, 15874-5 and DIN 8077/8078 (as regards for the dimension and ranges of pressure for piping in polypropylene), ASTM F2389, for the transport of potable hot and cold water intended for human consumption, for warming, conditioning, compressed air and mechanical systems in general. Suitable for the conveyance of fluids at a maximum continuous working temperature of 80°C for 25 years at a maximum pressure of 4,8 bar (with SF=1,25) and a maximum limit temperature of 95°C at 3,6 bar for 10 years (with SF=1,25). It is suitable for the contact with potable water. Colour: white with green stripes. Brand: Aquatechnik.